

Near the State Line.

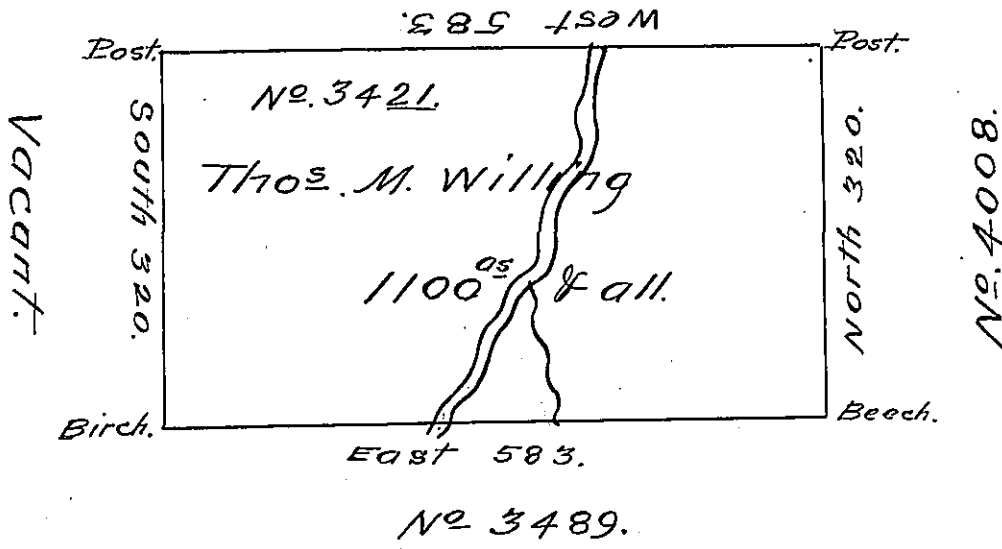

Situate on the Towanwant Creek about twenty perches South of the State Line, in North<sup>d</sup> County containing 1100 acres and the usual allowance for Roads &c. Surveyed June 27<sup>th</sup>. 1793. for Thomas M. Willing in persuance of a Warrant No. 3<sup>(alt)</sup> 21 bearing date December 14<sup>th</sup> 1792.

James Hunter D.S.

Daniel Brodhead Esqr. S.G.

IN TESTIMONY that the above is a copy of the original remaining on file in the Department of Internal Affairs of Pennsylvania, made conformably to an Act of Assembly approved the 16th day of February, 1833, I have hereunto set my Hand and caused the Seal of said Department to be affixed at Harrisburg, this fifteenth day of April 1907.

*Isaac B. Brown*  
 Secretary of Internal Affairs.